



Rosink can carrier and can changer





We keep
an eye on the
sliver layer
quality.

From now on, you can have an almost unlimited option in location of the new generation of can coilers. The compact design and the integrated servo drives reach a high level of independence. Only

Patented coiler head

- patented friction wheel drive
- suitable for all fibers between 4 and 50 g/m
- Coiler speeds up to 400 m/min
- no lubrication points
- maintenance-free concept
- low noise level

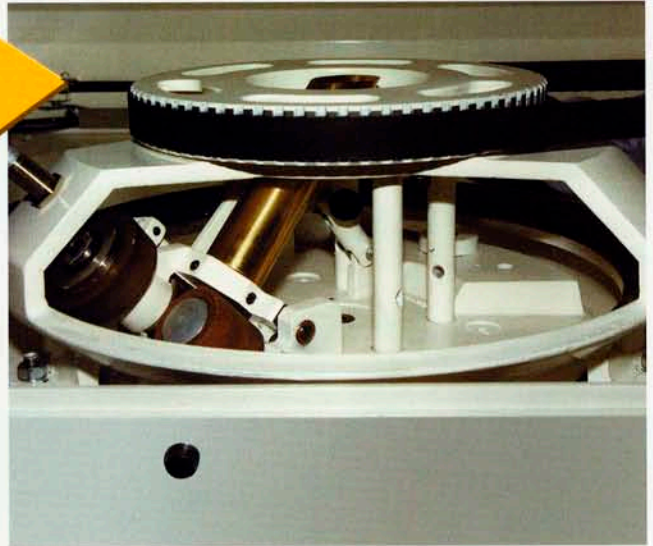

Patented press plate

- lowest impairment of the sliver quality
- allows high can filling grades
- less static load of synthetic fiber materials
- exact sliver coiling

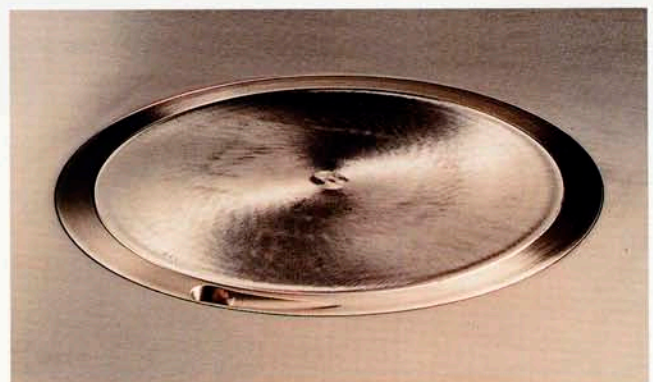

Patented sliver cutting

- sliver separation possible even at full production speed
- suitable for all fiber materials
- reproducible position of the sliver ends

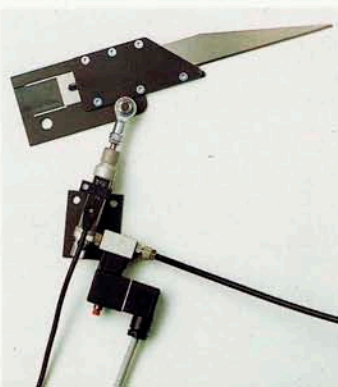

an electronic cable and the sliver connect the can coiler with the sliver delivery machine. Rosink also sets new standards regarding ease of servicing with the coiler type RS. The consistent modular system

and the restriction to the fewest possible number of moving parts render the products reliable and nearly maintenance-free. The synchronous operation of carding machine and can coiler is

Rosink coiler head

- for sliver heavier than 25 g/m with suction and sliver cutting device.

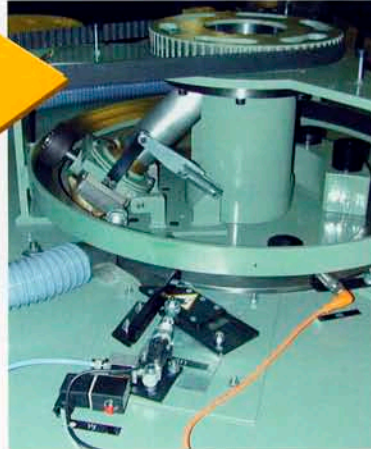

Rosink Double RS

- Two slivers in two cans



Display RS Machine

- Adjustment of can filling grade
- Integrated sliver length counter
- Display of error messages
- Adjustment of sliver tension and distance of the layers during operation
- 20 programs storable
- Shift program available as option



Electrical cabinet

- modern servo-technology
- 100 % synchronous running with sliver delivery machine
- suitable for autoleveller
- alternatively with own drive for can turning table

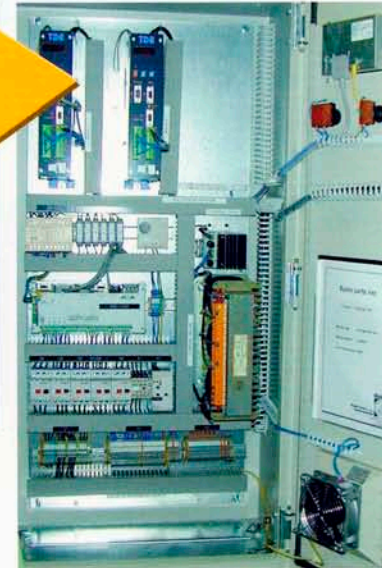

Rosink RSW KWR 1000

- attached to Rieter-Card C 50



guaranteed by an electronic shaft.
 The possibility of retrofitting the
 can coiler type RS with the changer
 type KWR or KWS makes it very
 flexible. Consequently it can easily
 be adapted to your further needs.



**Rosink
 RS KWR 1000
 4-cans**

- cans 1000 x 1200
- attached to
 Davis & Furber
 Pin Drafter

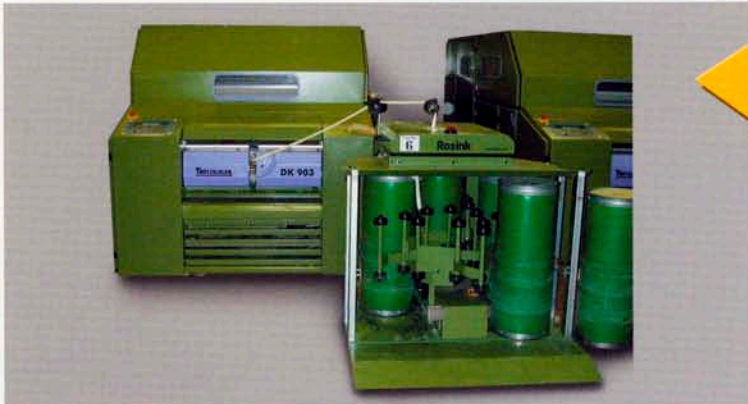

**Rosink
 RS KWR 350
 5-cans**

- cans 350 x 900
- attached to
 Trützschler-Card
 DK903



**Rosink
 RS KWS 900**

- attached to
 Trützschler-Card
 DK803



**Retrofitting
 (RS KWR 1000
 attached to Rieter
 C1/2)**

- Increase of
 efficiency
- higher can dia-
 meters possible
- easy to install

Technical Data

Dimensions RS KWR

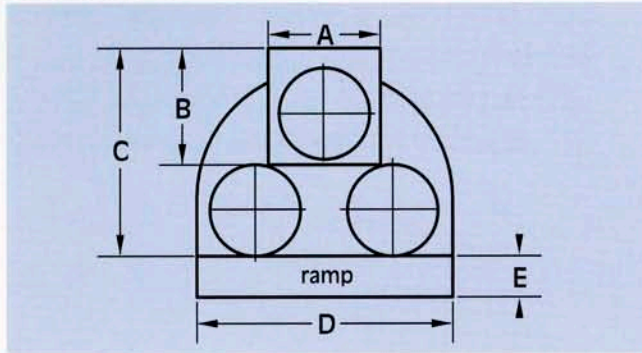

	can diameter in mm								
	ø 400*	ø 450*	ø 500*	ø 600	ø 750	ø 800	ø 900	ø 1000	ø 1200
A	820	820	820	820	1020	1020	1220	1220	1420
B	880	880	880	880	1060	1060	1260	1260	1460
C	1310	1360	1360	1460	1850	1900	2130	2220	2600
D	1420	1620	1620	1820	2120	2220	2420	2620	3020
E	500	500	500	400	400	400	300	300	300

*Can changer with 5 cans
Subject to technical modifications

Dimensions RS KWS

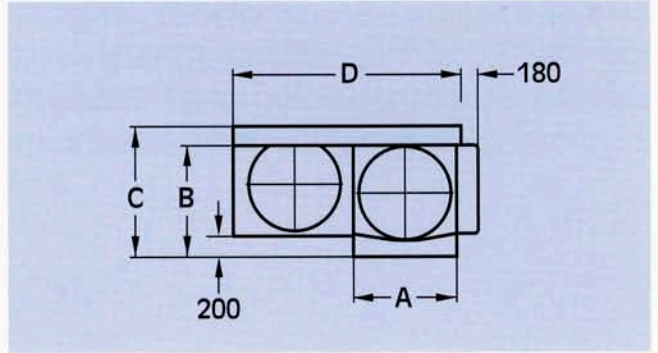

	can diameter in mm					
	ø 600	ø 700	ø 750	ø 800	ø 900	ø 1000
A	820	1020	1020	1020	1220	1220
B	880	1060	1060	1060	1260	1260
C	1090	1270	1270	1270	1470	1470
D	1770	2170	2170	2170	2570	2570

Machine type	Can coiler RS andrevolver can changer KWR ...linear can changer KWS
Can diameter	350-1200 mm (KWR) 600-1200 mm (KWS)
Can height	700-1600 mm
Sliver weight	Standard: 4-20 g/m Option: 20-35 g/m and 35-50 g/m
Sliver material	All spinnable fibers
Delivery speed	Standard: up to 400 m/min
Standard drive	Coiler head: brushless AC Servomotor 0,6 kW Capstan drive (KWR): three phase current motor 0,37 kW
Voltage supply	400V three phase 50/60 Hz other voltages optionally available Installed power: 3 kVA
compressed air connection	6-8 bar
Operating voltage	Filter control is fitted (KWS) 24 V
Control	Drives: digital drive control Changer: integrated PLC control Program storage: via EPROM
Setpoint input	Incremental transducer to be mounted at carding machine. Adaptation via PLC. Operation in perfect synchronism
Acceleration	2 s from 0 - max speed
Tensioning delay	Adjustable +/- 25 %
No of layers/can rot.	Adjustable +/- 25 %
Sliver monitoring	Photo electrical
Maintenance	All drives and bearings are maintenance free (exception KWS: lubrication of polygon shaft, 1 x per year)
Safety equipment	Safety switch for coiler hood
Equipment	The machine is delivered completely equipped and ready for operation
Options	Sliver length measuring de- vice, sliver separating system, Can turning plate with brush- less AC Servomotor 0,25 kW with planetary gearing, display with sliver length measuring device
Delivery	Completely mounted on a pallet (moisture resistant)



Rosink: Partner for textile solutions

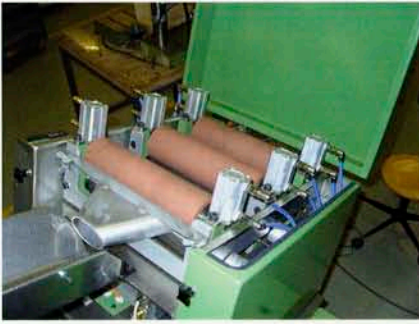

Rosink long staple drafting unit 3/3-RLS without autolevelling

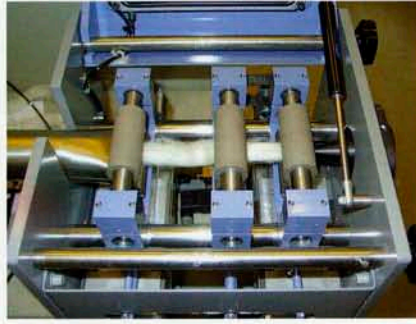

Rosink short staple drafting unit 3/3-RKS with autolevelling

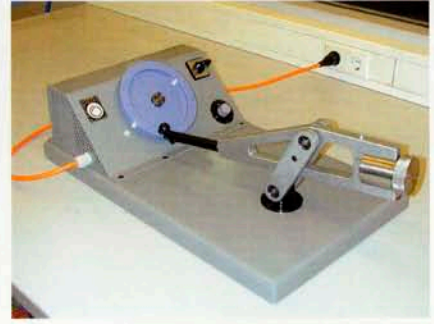

Rosink felting test machine



Rosink service machines for your cot maintenance workshop



Rosink flat mounting machine RFM 60 (Also applicable for your 40" flats)



Rosink universal grinding apparatus SM6 for bare cylinder and metallic wire grinding



Timmer stainless steel rollers

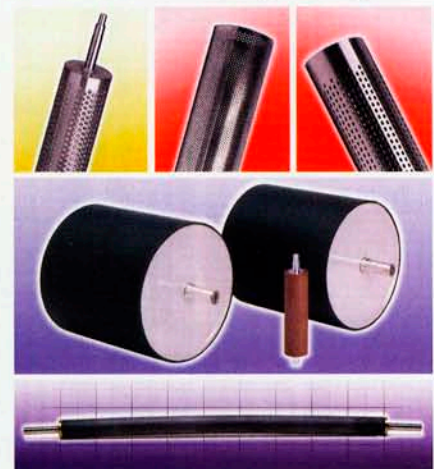

Timmer rollers

QUALITY MANAGEMENT
Certificate

Voluntary participation in regular monitoring according to ISO 9001:2000



Rosink GmbH + Co. Maschinenfabrik



Bentheimer Str. 207
D-48529 Nordhorn
Germany

Phone ++49(0)5921/7809-0

Fax ++49(0)5921/7809-10

E-mail: maschinenfabrik@rosink.de

www.rosink.com